

PRODUCT CONSTRUCTION EXAMPLE

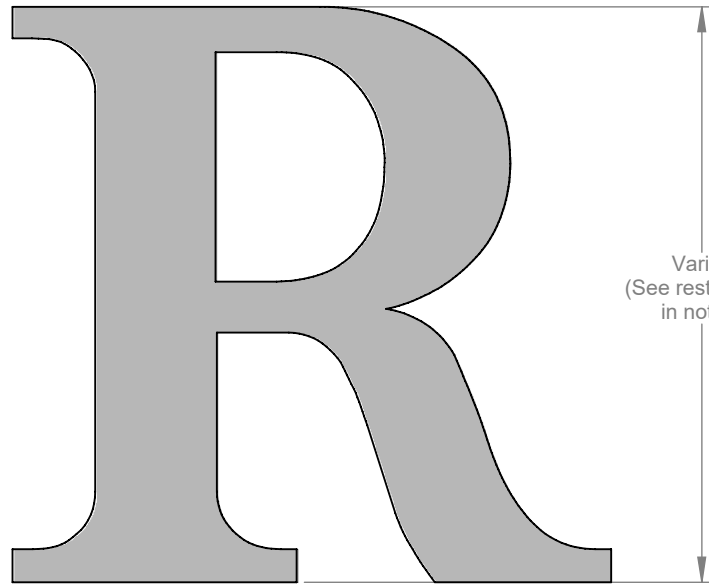

FRONT VIEW II SCALE 1:2

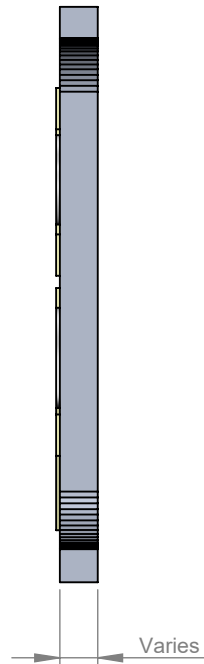

SIDE VIEW II SCALE 1:2

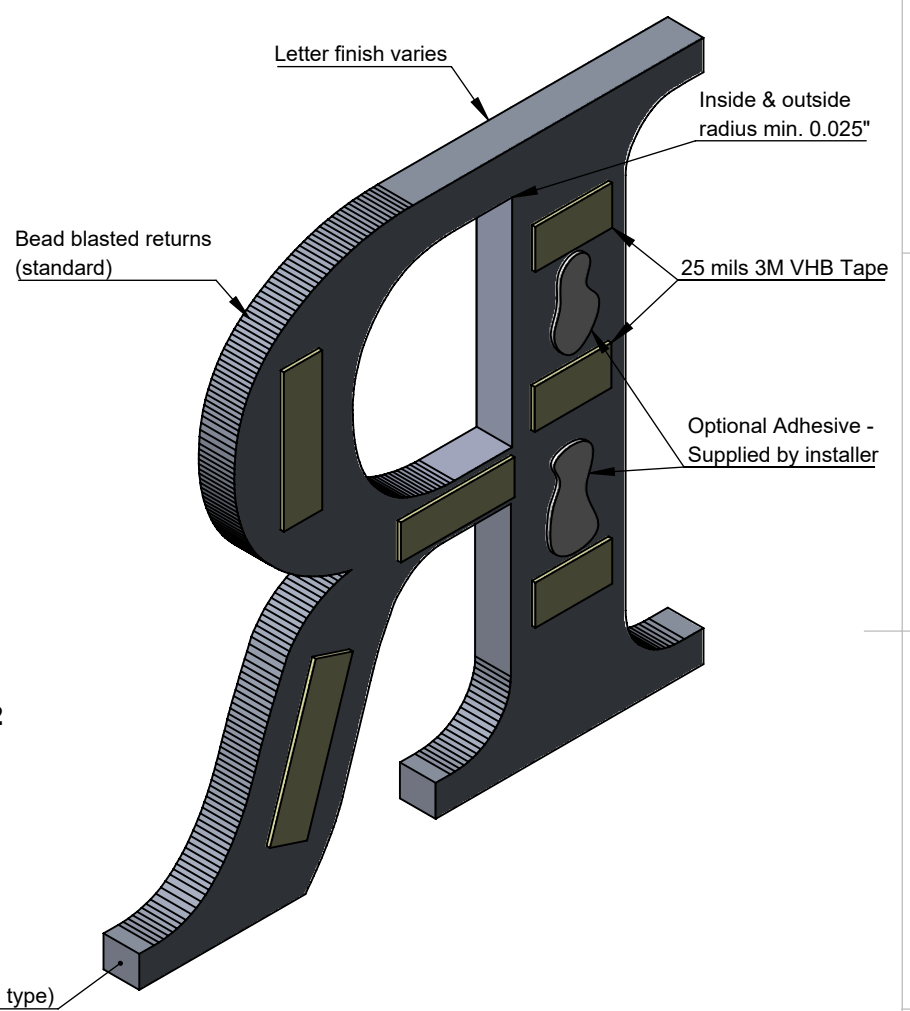

ISOMETRIC BACK VIEW II SCALE 1:1.5

**NOTES:**

- Exterior grade tape - recommended for interior installs only, on flat, smooth, surfaces
- Multiple face finish options
- Partial tape only - min. 1/4" stroke
- Aluminum - max. 6" x 6" pieces
- Other metals - max. 4" x 4" pieces
- Letters or logos, standard or custom



TITLE:

**FLAT CUT METAL - DOUBLE FACE TAPE MOUNT**

MATERIAL:

**METAL**

PRODUCT TYPE:

**FLAT CUT METAL**

DWG NO. FTMT90

REV. 10/25/16

SCALE: AS INDICATED

SHEET 1 OF 1